

Elpas



ALC LF Bus Beacon



ALC LF Bus Beacon

The Elpas ALC LF BUS Beacons are supervised 125KHZ field emitters. They add real-time location, choke point awareness to Elpas Security, Safety & Visibility solutions. The ALC LF BUS Beacons generate a user adjustable field. Indoor ALCs can be deployed in Primary – Secondary topologies to cover large double doors or complex indoor entrance/exit areas. Outdoor ALC with Loop supports loop cable lengths of 10-80m to match different size areas. ALCs contain a variety of Input, Output, and Wiegand options for control and supervision of doors as well as integration with third party access controllers. Should an individual or asset bearing an Elpas Active RFID tag enter the field emitted by a beacon, the tag is prompted to transmit a message indicating its presence at this location. The messages are received by nearby Elpas RF BUS readers or by Elpas Local Controllers and can either be locally processed or relayed over Ethernet/Wi-Fi networks to an RTLS host application, such as Eiris, to trigger location alerts or to identify the precise location and status of the tag.

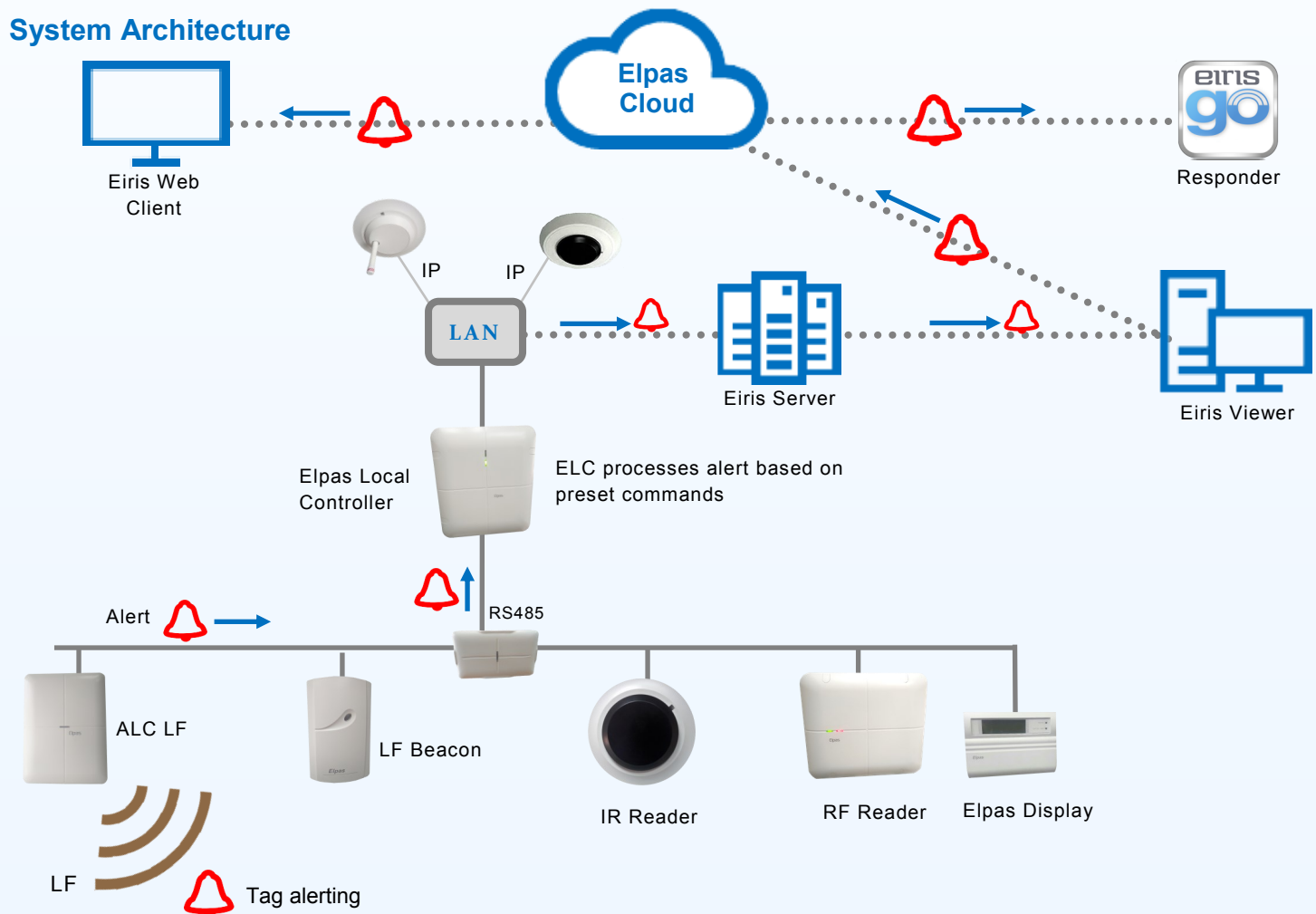

ALC LF Beacon

Features

- Ethernet or RS-485 options
- Real-time tag monitoring and tracking
- 4m range—Tunable
- Read range up to 4m/13ft radius (360° coverage)
- Sub-Room location detection
- Fully supervised, includes tamper protection
- ID via DIP switches
- Add Hands-Free to standard A/C via Wiegand Interface
- Low power consumption
- Onboard I/O ports
- XML messaging technology
- CE, FCC, IC compliant

Applications and Uses

- Personnel or Patient Identification
- Assisted living or retirement communities
- Infant protection
- Nurse/patient call
- Entrance/Exit based alarming
- Hands-free access control
- Asset management and loss prevention
- Visitor Safety



Outdoor ALC LF

Specifications

Technology	Low frequency field (125 KHz)
*Output Ranges	Eight user selectable ranges
Transmission Rates	Continuous bursts of LF transmissions
Rs-485 Bus	230Kbit/sec
Device Supervision	Lost Away, Low Voltage, Communication Problems, Enclosure Tamper
Buzzer	Invalid ID Code: Beeps continuously
Orange LED	Device connected and registered in Eiris or ELC Continuous: when front cover is not properly closed Flasher: can be driven remotely
Green LED	Firmware download: flashes when front cover is not properly closed Flashes more frequently: can be driven remotely
Red LED	Invalid ID Code: flashes unregistered in Eiris software Flashes: power-up/communication loss Flashes: when front cover is not properly closed Each type of flash becomes more frequent: can be driven remotely
ID Code	Set by an onboard, position DIP switch
Inputs/Outputs	Terminals 1 and 2: Two digital inputs (rated 100mA/12VDC) or one 26-bit Wiegand output Terminal 3: Supervised dry contact input or O.C. output
Input Supervision	4 levels: Open, Closed, Line Short, Line Cut, using optional Elpas End-of-Line terminator
Power Requirements	12-18Vdc, 55mA @24VC, 500mA @ 24VDC max. Approved limited power supply
Construction	Indoor: White ABS plastic Outdoor: with Loop: White polycarbonate plastic
Dimensions (H x W x D)	Indoor: 130.2x175.1x28.75mm / 5.1x.6.9x1.1in Outdoor: Exterior 192x164x87mm / 7.5x6.4 x3.4in Interior: 175x150x80mm / 6.8x5.9x3.1
Weight	Indoor: 306.44g / 10.8oz Outdoor with Loop 530g / 18.7oz
Tamper Protection	Indoor: two-contacts, between the PCB and the front over and the PCB tray Outdoor: optical
Device Interfaces—IP	Ethernet: Female RJ-45 (8P8C) connector RS-485 Data Bus & Power: female RJ-11 (6P6C) or four-position removable terminal block Analogue Input: Four-position fixed terminal block Digital Output: Four-position fixed terminal block
Device Interfaces—Bus	RS-485 Data Bus & Power: one female RJ-11 (6P6C) connector Supervised Input: two-position terminal block Primary/Secondary Output Field Synch: two-position terminal block Optional 26 bit Wiegand Outputs: two-position terminal block

Specifications (continued)

Operating Environment	Temperature: -30°C to 60°C / -22°F to 140°F Humidity: 20% to 80% non-condensing
Management Software	Eiris V4.9.1 (or higher) software
Warranty	1-year limited warranty
<p>*Note: The output range (for each range mode) may vary +/- 20% by specific Active RFID Tag as well as the tag's physical orientation in relation to the LF field and various environmental factors including structural reference. Specifications are subject to change without notice.</p> <p>**All specifications are subject to changes without notice</p>	

Accessories

5-ALC90001	LF Mounting Bracket (set of 5) *For indoor
P-ALC0010	Outdoor Enclosure for LF Beacon
5-TRC00433-2	RF transmitter for LF Beacon
5-JBA10485	RS-485 Junction Box, 4 RJ11 Ports
5-LFM00125	LF Field Meter
5-IOX00001	End-of-Line Terminator for Elpas & AXS Inputs (5 units)
For a complete list of compatible accessories, please contact your local Elpas Sales Representative.	

Location Based Security RTLS

Cabling Options

Part Number	Type
**5-ERS02721-5	Network Drop Cable, 5 Meters
**5-ERS02800	P60 Power Supply, 24VDC/2.2A
*5-ERS01905-15P	Network Drop Cable, 15 Feet, Plenum Rated
*5-ERS01905-30P	Network Drop Cable, 30 Feet, Plenum Rated
*5-ERS02603	Power Supply, 24VDC, 10 Amp, Linear
*5-ERS02605	Power Supply, 24VDC, 6 Amp, Linear

Ordering Information

Part Number	Type
5-ALC01021-0	ALC Indoor LF Bus Beacon
5-ALC01023-0	ALC Outdoor LF Bus Beacon with Loop

*Available only in the Americas / ** Not Available in the Americas

Product offerings and specifications are subject to change without notice

Not all products include all features

Related Products

Local Controller



Junction Box



Display Panel



IR Reader



Elpas

www.elpas.com

All Rights Reserved

Elpas is global provider of scalable Passive & Active RFID/RTLS Safety, Security and Visibility Solutions for Healthcare, Manufacturing, Logistics and Building Automation. Elpas delivers a complete line of real-time location based security solutions that help enhance individual safety, reduce property shrinkage, streamline operational workflows, protect the vulnerable, lessen negligence litigation and facilitate industry guideline compliance. Elpas currently serves customers throughout the Americas, the U.K., EMEA and Asia-Pacific.